

**MICRO SWITCH**  
a Honeywell Division

FED. MFG. CODE 91929

**SWITCH-BASIC**

CATALOG LISTING

V7-1S17D8-263

CW-B8655

CATALOG LISTING  
**V7-1S17D8-263**  
 PAGE 1 OF 1  
 RELEASE NO. PR-18499  
 REPLACES  
 ISSUE  
**M**  
 5  
 CHECK  
 REVISIONS  
 A CO-69205  
 BAB  
 7 JAN 91  
 B CO-76198  
 J A L  
 17 NOV 93  
 C CO-77116  
 DCS  
 31 MAR 94  
 D CO-93311  
 TSM  
 22 OCT 98  
 CHECK  
 22 AUG 90  
 WJC  
 CHECK  
 15 AUG 90  
 W L S  
 DRAWN  
 FORMTEK

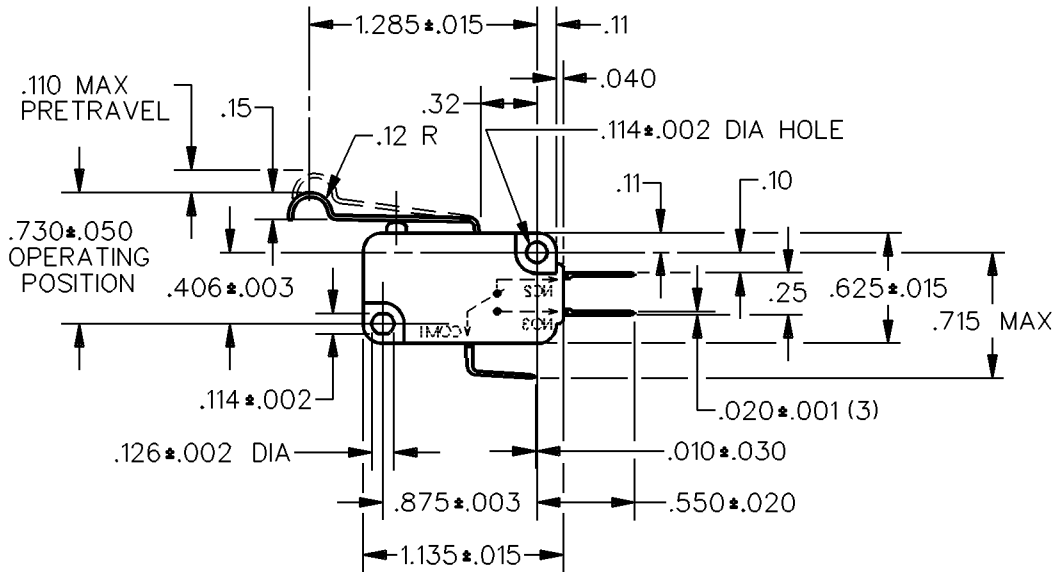
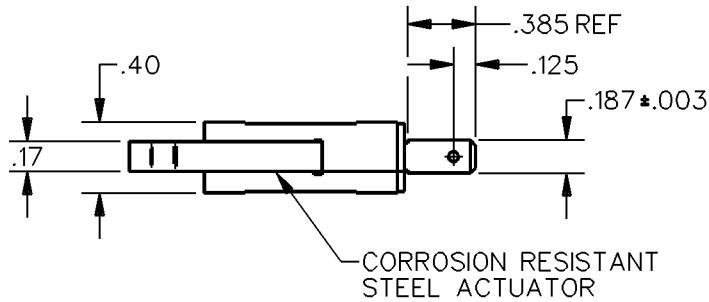

NOTE  
 1 - IN INSPECTION, DO NOT BURN OUT - GOLD CONTACTS  
 2 - IN INSPECTION, DO NOT EXCEED 10 VDC, .1A RESISTIVE LOAD

THIS DRAWING COVERS A PROPRIETARY ITEM AND IS THE PROPERTY OF MICRO SWITCH, A DIVISION OF HONEYWELL. THIS DRAWING IS NOT TO BE COPIED OR USED WITHOUT THE APPROVAL OF MICRO SWITCH.

THIRD ANGLE PROJECTION

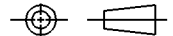

CHARACTERISTICS	ELECTRICAL DATA CONTACT ARRANGEMENT S P D T	SCALE	FULL	DO NOT SCALE PRINT
		<b>UNLESS OTHERWISE SPECIFIED TOLERANCES ARE</b>		
OPERATING FORCE -----90 GRAM MAX	0.1A 125 VAC L142	ONE PLACE	(.0)	±.030
RELEASE FORCE -----9 GRAM MIN		TWO PLACE	(.00)	±.015
DIFFERENTIAL TRAVEL-----.030 MAX		THREE PLACE	(.000)	±.005
OVERTRAVEL -----.075 MIN		ANGLES		±
RELEASE TRAVEL -----.015 MIN		WEIGHT		

